

N J W Series

N
J
W



Waterproof equivalent to IP-67

Safety standard certified products available

RoHS

Overview

- Waterproof connectors based on NJC Series.
- As with NJC Series, a wide variety of types available.
- Proven performance in outdoor installations such as surveillance cameras, construction machines and outdoor measuring equipment.

Feature

RoHS	RoHS Directive compliant
Waterproof	Waterproof connector 【 Waterproof function equivalent to IP-67 when coupled 】
Lock method	Thread lock
Features of mechanism/ material	<ul style="list-style-type: none"> ○ Die cast shell with zinc alloy or aluminum alloy. ○ Smooth coupling thanks to employment of 5-key system guide. ○ Installation in a small space enabled by use of the L za.
Standards	<ul style="list-style-type: none"> ○ UL • CSA standard certified connectors available. (UL : UL1977 CSA : C22.2 No.182.3) <p><small>Note: The specifications of safety standard certified products are slightly different from those of standard products. For the rated voltage, current and cable conductor cross sectional area, refer to A List of Standards Acquired (p.128).</small></p>
Cable termination	Soldering

Characteristics

Insulation resistance , Withstand voltage , Contact resistance , Waterproof p.92



The pin contact type has an **exposed electrode**. If it is used on the [power supply] side, it may cause **electric shock** or **short-circuit accidents**. To prevent such accidents, use the socket contact type on the [power supply] side and the pin contact type on the [equipment] side.

N J W Series

Product No. designation

NJW - 24 ■ - P M □

① ② ③ ④ ⑤ ⑥ ⑦ ⑧ ⑨

- ① Series designation
- ② Shell size
- ③ Number of contacts
- ④ Shell shape
- ⑤ Contact shape < Pin (male) contact : M , Socket (female) contact : F >
- ⑥ K type symbol (K) 《 Required only for products with settings 》
- ⑦ Guide position change symbol (X , Y , Z) 《 Required only when changing the guide position 》
- ⑧ Symbol indicating cable packing size. 《 Plug & adapter require symbol to be specified. 》
- ⑨ Safety standard specification (< UL • CSA >)
《 Required only when safety standard is to be specified. 》 For applicable products, see p.128.

《Option》

- When using a plural number of same products at the same time, the guide position can be changed in order to prevent mis-insertion.
(For applicable products, see below.)
- Product name example : NJW-2010-PFX
- Guide position change symbol (X , Y , Z) in the red character part.

Cable termination : Soldering

Material and Finish

	Material	Finish
Shell	Shell size 16 , 20 , 24 : Zinc alloy (Partially aluminum alloy) Shell size 28 , 32 : Aluminum alloy	Special treatment
Insulator	Synthetic resin	—
Contact	Copper alloy	Silver plating Gold plating
Packing	Synthetic rubber	—

Operating temperature range

Shell size	Number of Contacts	Operating temperature range
16	3, 5	-25°C to +85°C
20	2, 3, 4, 5, 7, 10, 12	
24	2, 3, 4, 5, 10, 14, 16	
28	16, 24	
32	3, 4	
16	8	-25°C to +60°C
20	14	
24	21, 24	
28	31, 37	
32	8, 10, 12	

To change the guide position (Following number of contacts only)

Shell size	Number of Contacts	Guide Position Symbol		
		X	Y	Z
16	* 3	30°	60°	180°
	* 5	45°	90°	315°
20	7	30°	—	—
	* 10	45°	90°	315°
	12		95°	190°
24	10	45°	90°	315°
	14			
	16			
28	16	45°	90°	315°
	24			

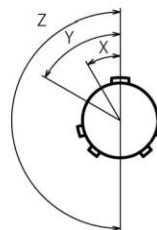

An image of guide position change

< When viewed from the pin (male) contact side coupling face >

* UL • CSA products supported also.

Soldering Type Contact arrangement

[] : Gold plating contact

Shell size	Number of Contacts	3	5	8						
16	Contact arrangement <When viewed from the pin (male) contact coupling side>									
	Safety standard (Note-1)	UL·CSA			—					
	Rating (Allowable current for signals)	125V			—					
	Withstand voltage (V r.m.s.)	1,500	1,000	500						
	Wire size (mm ²)	1.25	0.5	0.3						
	Remarks	—			For signals					

Shell size	Number of Contacts	2	3	4	5	7	10	12	14		
20	Contact arrangement <When viewed from the pin (male) contact coupling side>										
	Safety standard (Note-1)	UL·CSA								—	
	Rating (Allowable current for signals)	250V				—					
	Withstand voltage (V r.m.s.)	15A			10A		5A		[3A]		
	Wire size (mm ²)	1,500			1,000		500				
	Remarks	2			1.25		0.5		0.3		For signals

Shell size	Number of Contacts	2	3	4	5	10	14	16	21	24	
24	Contact arrangement <When viewed from the pin (male) contact coupling side>										
	Safety standard (Note-1)	UL·CSA								—	
	Rating (Allowable current for signals)	250V									
	Withstand voltage (V r.m.s.)	20A			15A		10A	5A		3pcs=6A [18pcs=3A]	[3A]
	Wire size (mm ²)	1,500			1,000		500				
	Remarks	3.5			2		1.25	0.5		3pcs=0.75 18pcs=0.3	0.3

Note-1 : Specified separately. "Specified as a set of UL and CSA". For safety standards, see p.128.

Soldering Type Contact arrangement

[] : Gold plating contact

Shell size	Number of Contacts	16	24	31	37						
28	Contact arrangement <When viewed from the pin (male) contact coupling side>										
	Safety standard (Note-1)	UL·CSA		—							
	Rating (Allowable current for signals)	250V		—							
		10A	5A	3pcs=6A [28pcs=3A]	[3A]						
	Withstand voltage (V r.m.s.)	1,000		500							
	Wire size (mm ²)	1.25	0.5	3pcs=0.75 28pcs=0.3	0.3						
Remarks	—		For signals								

Shell size	Number of Contacts	3	4	8	10	12					
32	Contact arrangement <When viewed from the pin (male) contact coupling side>										
	Safety standard (Note-1)	UL·CSA									
	Rating (Allowable current for signals)	250V									
		30A		10A							
	Withstand voltage (V r.m.s.)	2,000		1,500							
Wire size (mm ²)	5.5 , 6		2								
Remarks	—										



Note-1 : Specified separately. "Specified as a set of UL and CSA". For safety standards, see p.128.

NJW Series Shell Size 16

[Power receiving side] < Pin (male) contact used >

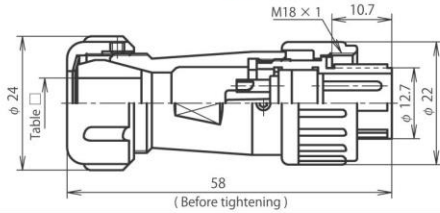

NJW-16 ■ -PM □

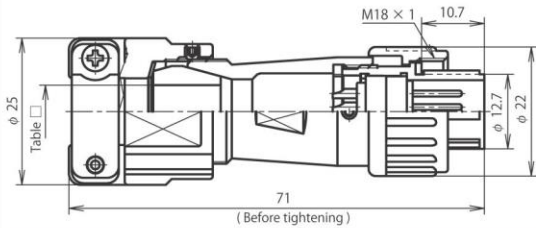

NJW-16 ■ -PMK □

G Type

[Power supply side] < Socket (female) contact used >

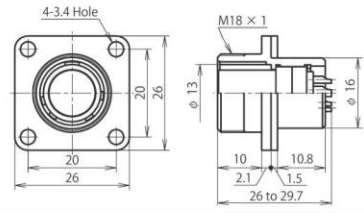

NJW-16 ■ -RF

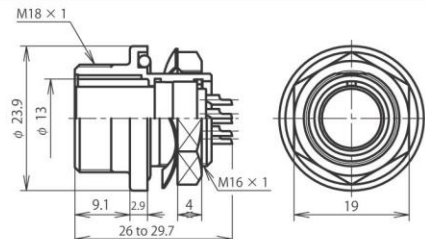

NJW-16 ■ -RBF

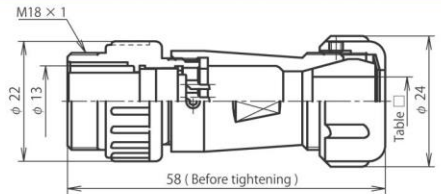

NJW-16 ■ -AdF □

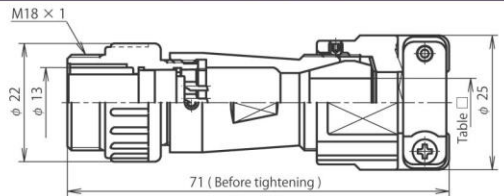

NJW-16 ■ -AdFK □

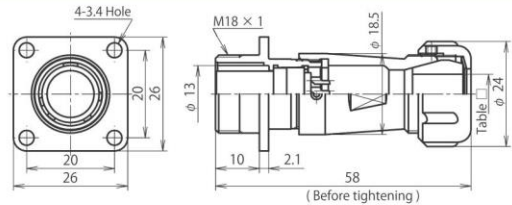

NJW-16 ■ -Ad(F)F □

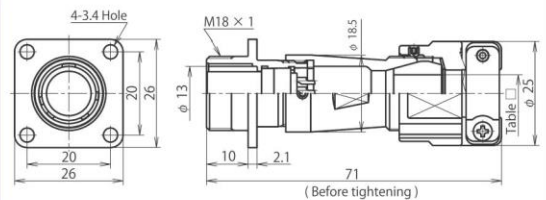

NJW-16 ■ -Ad(F)FK □

Plug

Coupled

Receptacle

Adapter

Cap · L za pp.90-91

For the plug and adapter, be sure to select □ (cable packing symbol).

Table □

In order to secure the intended waterproof function, a cable to be used for the plug/adapter should have an appropriate specification and structure.

Shell size	Symbol □	Outer diameter of cable used	Normal products		Safety standard	
			Standard	K Type	Standard	K Type
16	5	φ 4.0 to φ 4.8	●	—	—	—
	7	φ 5.7 to φ 6.8	●	●	—	—
	8	φ 6.9 to φ 7.9	●	●	—	—
	9	φ 8.0 to φ 9.4	●	●	●	—
	11	φ 9.5 to φ 11.0	●	●	●	—

■ indicates the number of contacts. Contact arrangement p.78. The conductor cross sectional area is less than the following value. However, for safety standard compliant products, use a cable having a value shown on p.128.

Shell size	Number of Contacts	3	5	8
16	Safety standard (Note-1)	UL · CSA		—
	Rating (Allowable current for signals)	125V 10A	125V 5A	[3A]
	Withstand voltage (V _{r.m.s.})	1,500	1,000	500
	Wire size (mm ²)	1.25	0.5	0.3
	Remarks	—		For signals

Note-1 : Specified separately. *Specified as a set of UL and CSA*. For safety standards, see p.128.

NJW Series Shell Size 16

NJW
16

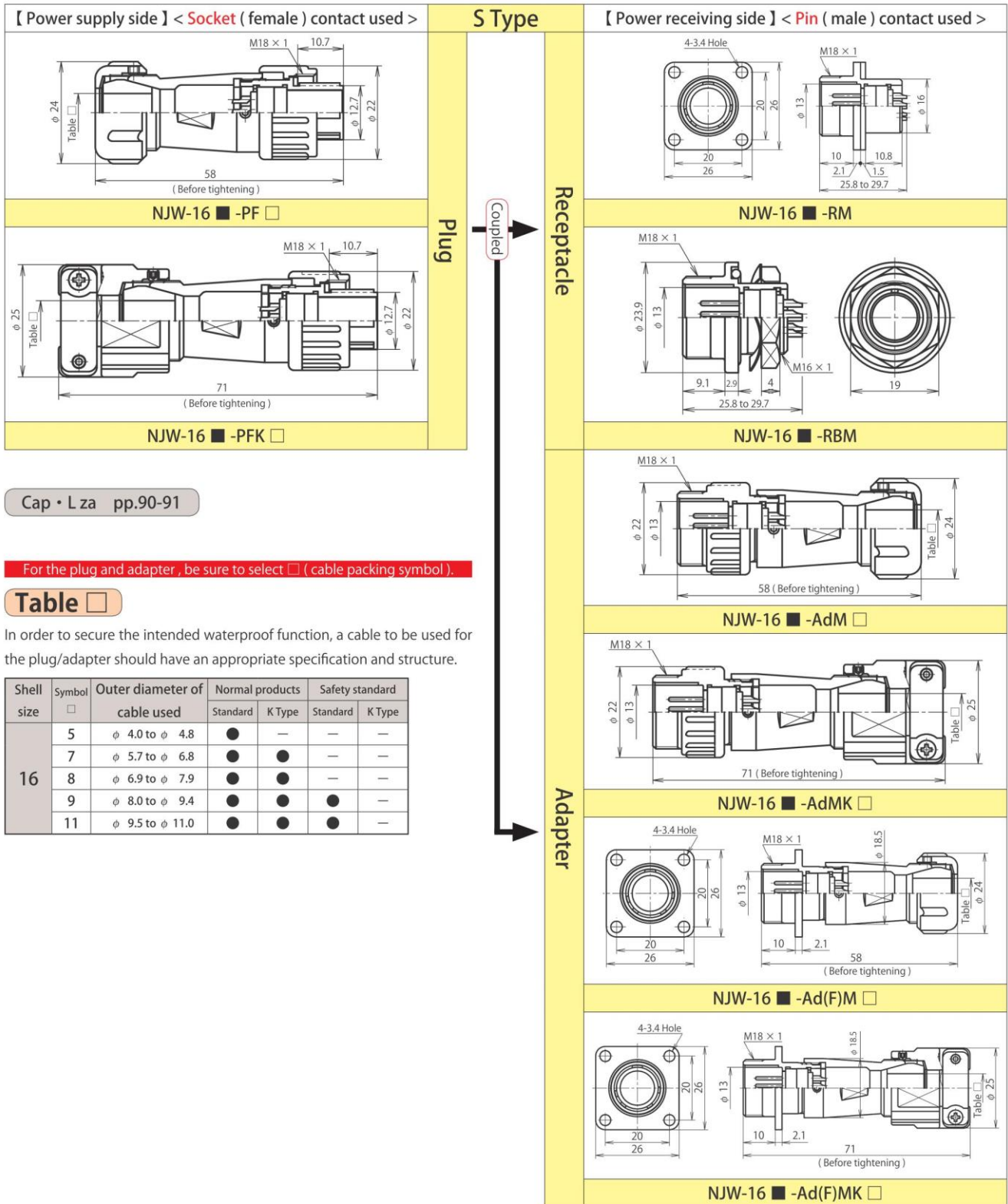

Cap · L za pp.90-91

For the plug and adapter, be sure to select (cable packing symbol).

Table

In order to secure the intended waterproof function, a cable to be used for the plug/adapter should have an appropriate specification and structure.

Shell size	Symbol <input type="checkbox"/>	Outer diameter of cable used	Normal products		Safety standard	
			Standard	K Type	Standard	K Type
16	5	φ 4.0 to φ 4.8	●	—	—	—
	7	φ 5.7 to φ 6.8	●	●	—	—
	8	φ 6.9 to φ 7.9	●	●	—	—
	9	φ 8.0 to φ 9.4	●	●	●	—
	11	φ 9.5 to φ 11.0	●	●	●	—

■ indicates the number of contacts. Contact arrangement p.78.
The conductor cross sectional area is less than the following value. However, for safety standard certified products, use a cable having a value shown on p.128.

Shell size	Number of Contacts	3	5	8
16	Safety standard (Note-1)	UL·CSA		—
	Rating (Allowable current for signals)	125V 10A	125V 5A	[3A]
	Withstand voltage (V _{r.m.s.})	1,500	1,000	500
	Wire size (mm ²)	1.25	0.5	0.3
	Remarks	—		For signals

Note-1 : Specified separately. *Specified as a set of UL and CSA". For safety standards, see p.128.

NJW Series Shell Size 20

【 Power receiving side 】 < Pin (male) contact used >

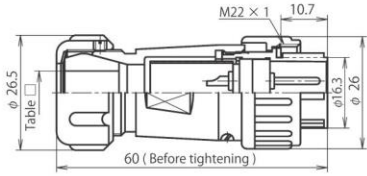

NJW-20 ■ -PM □

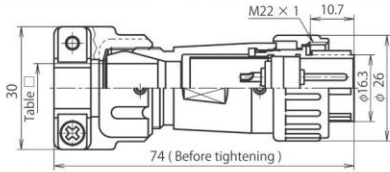

NJW-20 ■ -PMK □

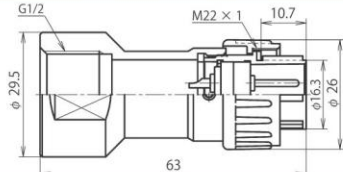

NJW-20 ■ -GPM1/2 (Note)

G Type

【 Power supply side 】 < Socket (female) contact used >

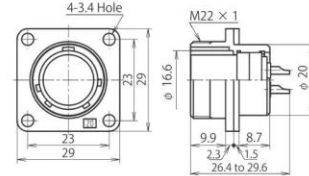

NJW-20 ■ -RF

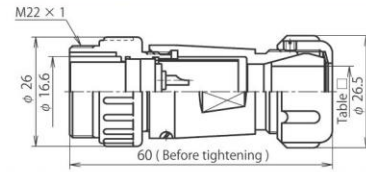

NJW-20 ■ -AdF □

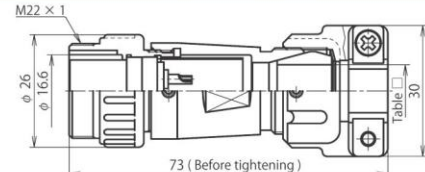

NJW-20 ■ -AdFK □

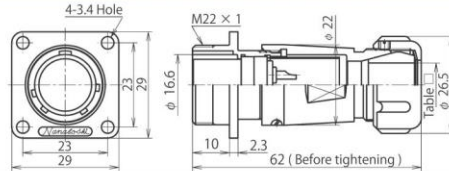

NJW-20 ■ -Ad(F)F □

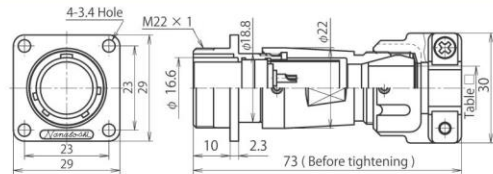

NJW-20 ■ -Ad(F)FK □

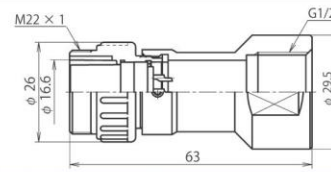

NJW-20 ■ -GAdF1/2 (Note)

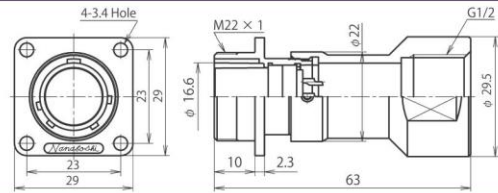

NJW-20 ■ -GAd(F)F1/2 (Note)

Plug

Coupled

Adapter

Note: We show sizes by the nominal "G(PF)" of parallel pipe threads. p.135
The waterproof of the conduit installation part depends on the conduit connecting components to use.

Cap • Lza pp.90-91

For the plug and adapter , be sure to select □ (cable packing symbol).

Table □

In order to secure the intended waterproof function, a cable to be used for the plug/adapter should have an appropriate specification and structure.

Shell size	Symbol □	Outer diameter of cable used	Normal products		Safety standard	
			Standard	K Type	Standard	K Type
20	6	φ 5.5 to φ 6.3	●	—	—	—
	8	φ 7.0 to φ 8.5	●	●	●	—
	10	φ 8.6 to φ 10.5	●	●	●	—
	12	φ 10.6 to φ 12.5	●	●	●	—

■ indicates the number of contacts. Contact arrangement p.78.
The conductor cross sectional area is less than the following value. However, for safety standard compliant products, use a cable having a value shown on p.128.

Shell size	Number of Contacts	2	3	4	5	7	10	12	14	
20	Safety standard (Note-1)	UL-CSA							—	
	Rating (Allowable current for signals)	250V 15A			250V 10A			250V 5A		[3A]
	Withstand voltage (V r.m.s.)	1,500				1,000				500
	Wire size (mm ²)	2			1.25			0.5		0.3
	Remarks	—							For signals	

Note-1 : Specified separately. "Specified as a set of UL and CSA". For safety standards, see p.128.

□ : Gold plating contact

NJW Series Shell Size 20

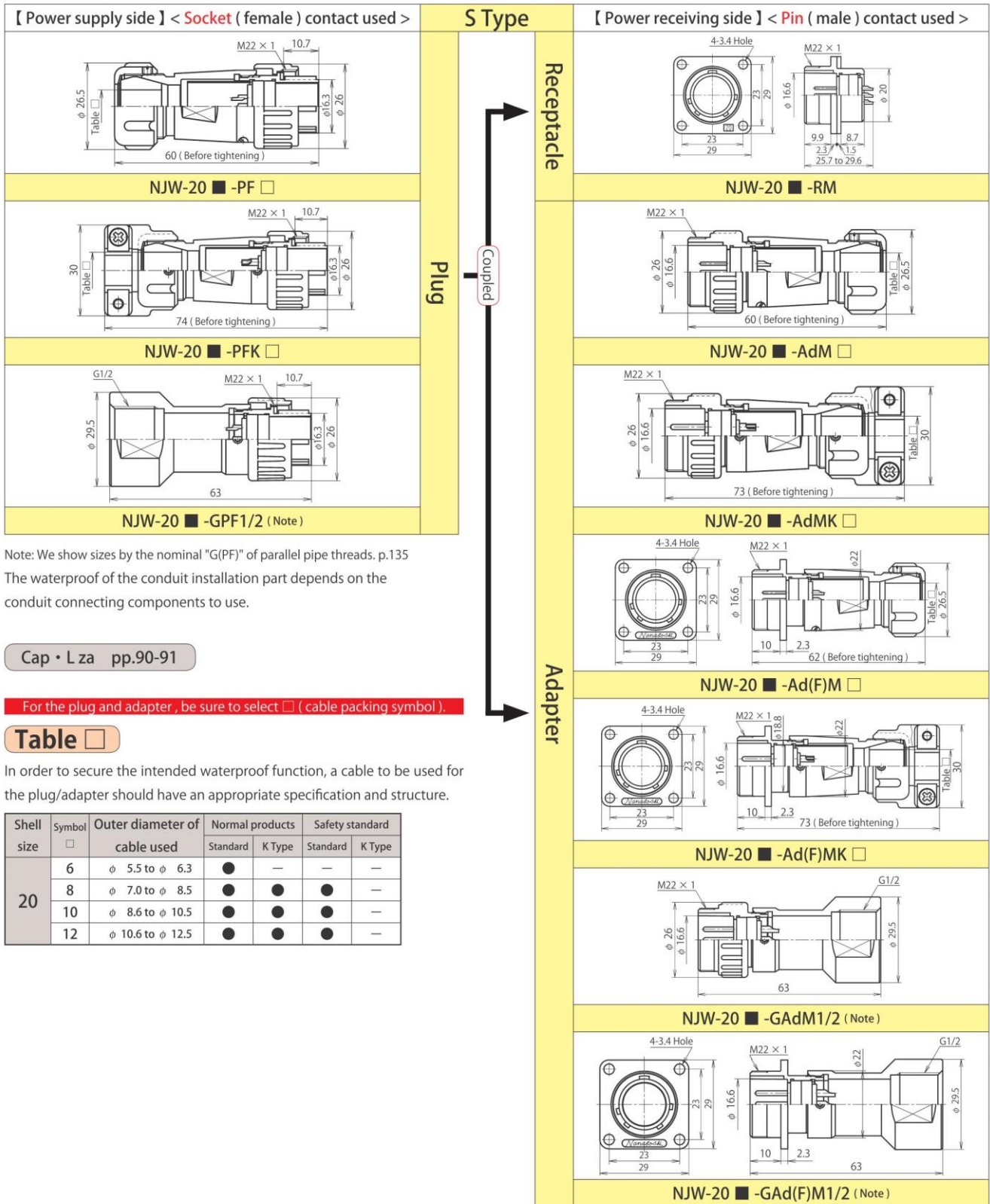

Note: We show sizes by the nominal "G(PF)" of parallel pipe threads. p.135
The waterproof of the conduit installation part depends on the conduit connecting components to use.

Cap • Lza pp.90-91

For the plug and adapter, be sure to select (cable packing symbol).

Table

In order to secure the intended waterproof function, a cable to be used for the plug/adapter should have an appropriate specification and structure.

Shell size	Symbol <input type="checkbox"/>	Outer diameter of cable used	Normal products		Safety standard	
			Standard	K Type	Standard	K Type
20	6	φ 5.5 to φ 6.3	●	—	—	—
	8	φ 7.0 to φ 8.5	●	●	●	—
	10	φ 8.6 to φ 10.5	●	●	●	—
	12	φ 10.6 to φ 12.5	●	●	●	—

■ indicates the number of contacts. Contact arrangement p.78.
The conductor cross sectional area is less than the following value. However, for safety standard certified products, use a cable having a value shown on p.128.

Shell size	Number of Contacts	2	3	4	5	7	10	12	14	
20	Safety standard (Note-1)	UL • CSA							—	
	Rating (Allowable current for signals)	250V 15A			250V 10A			250V 5A		[3A]
	Withstand voltage (V r.m.s.)	1,500				1,000				500
	Wire size (mm ²)	2			1.25			0.5		0.3
	Remarks	—							For signals	

[] : Gold plating contact

Note-1 : Specified separately. *Specified as a set of UL and CSA*. For safety standards, see p.128.

NJW Series Shell Size 24

【 Power receiving side 】 < Pin (male) contact used >

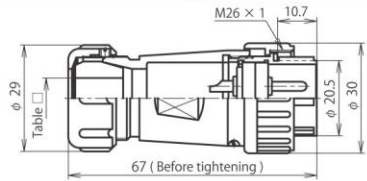

NJW-24 ■ -PM □

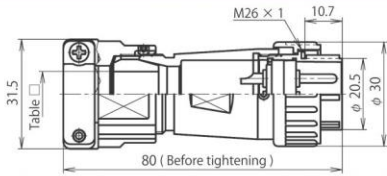

NJW-24 ■ -PMK □

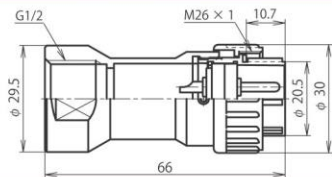

NJW-24 ■ -GPM1/2 (Note)

Note: We show sizes by the nominal "G(PF)" of parallel pipe threads. p.135
The waterproof of the conduit installation part depends on the conduit connecting components to use.

Cap • Lza pp.90-91

For the plug and adapter , be sure to select □ (cable packing symbol).

Table □

In order to secure the intended waterproof function, a cable to be used for the plug/adapter should have an appropriate specification and structure.

Shell size	Symbol □	Outer diameter of cable used	Normal products		Safety standard	
			Standard	K Type	Standard	K Type
24	8	φ 6.8 to φ 8.0	●	●	—	—
	11	φ 9.5 to φ 11.0	●	●	●	—
	13	φ 11.1 to φ 13.0	●	●	●	—
	15	φ 13.1 to φ 15.0	●	●	●	—

G Type

【 Power supply side 】 < Socket (female) contact used >

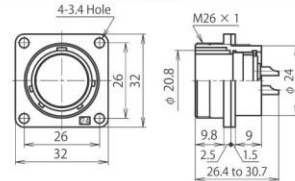

NJW-24 ■ -RF

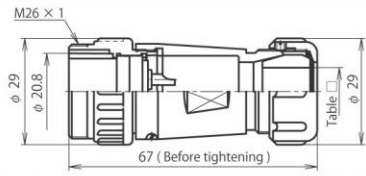

NJW-24 ■ -AdF □

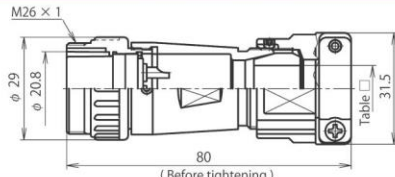

NJW-24 ■ -AdFK □

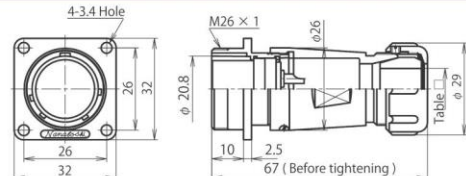

NJW-24 ■ -Ad(F)F □

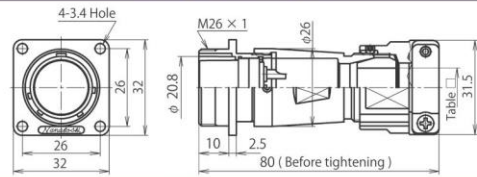

NJW-24 ■ -Ad(F)FK □

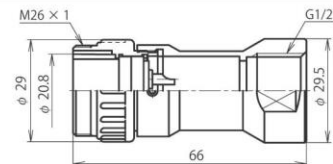

NJW-24 ■ -GAdF1/2 (Note)

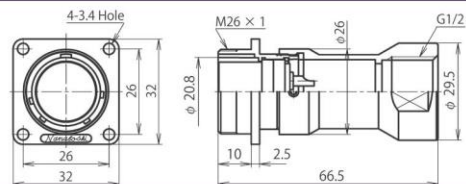

NJW-24 ■ -GAd(F)F1/2 (Note)

Plug

Coupled

Adapter

■ indicates the number of contacts. Contact arrangement p.78.

The conductor cross sectional area is less than the following value. However, for safety standard certified products, use a cable having a value shown on p.128.

Shell size	Number of Contacts	2	3	4	5	10	14	16	21	24
24	Safety standard (Note-1)	UL • CSA								
	Rating (Allowable current for signals)	250V 20A		250V 15A		250V 10A		250V 5A	3pcs=6A [18pcs=3A]	[3A]
	Withstand voltage (V r.m.s.)	1,500			1,000				500	
	Wire size (mm ²)	3.5		2		1.25		0.5	3pcs=0.75 18pcs=0.3	0.3
	Remarks	—								

[] : Gold plating contact

Note-1 : Specified separately. *Specified as a set of UL and CSA*. For safety standards, see p.128.

NJW Series Shell Size 24

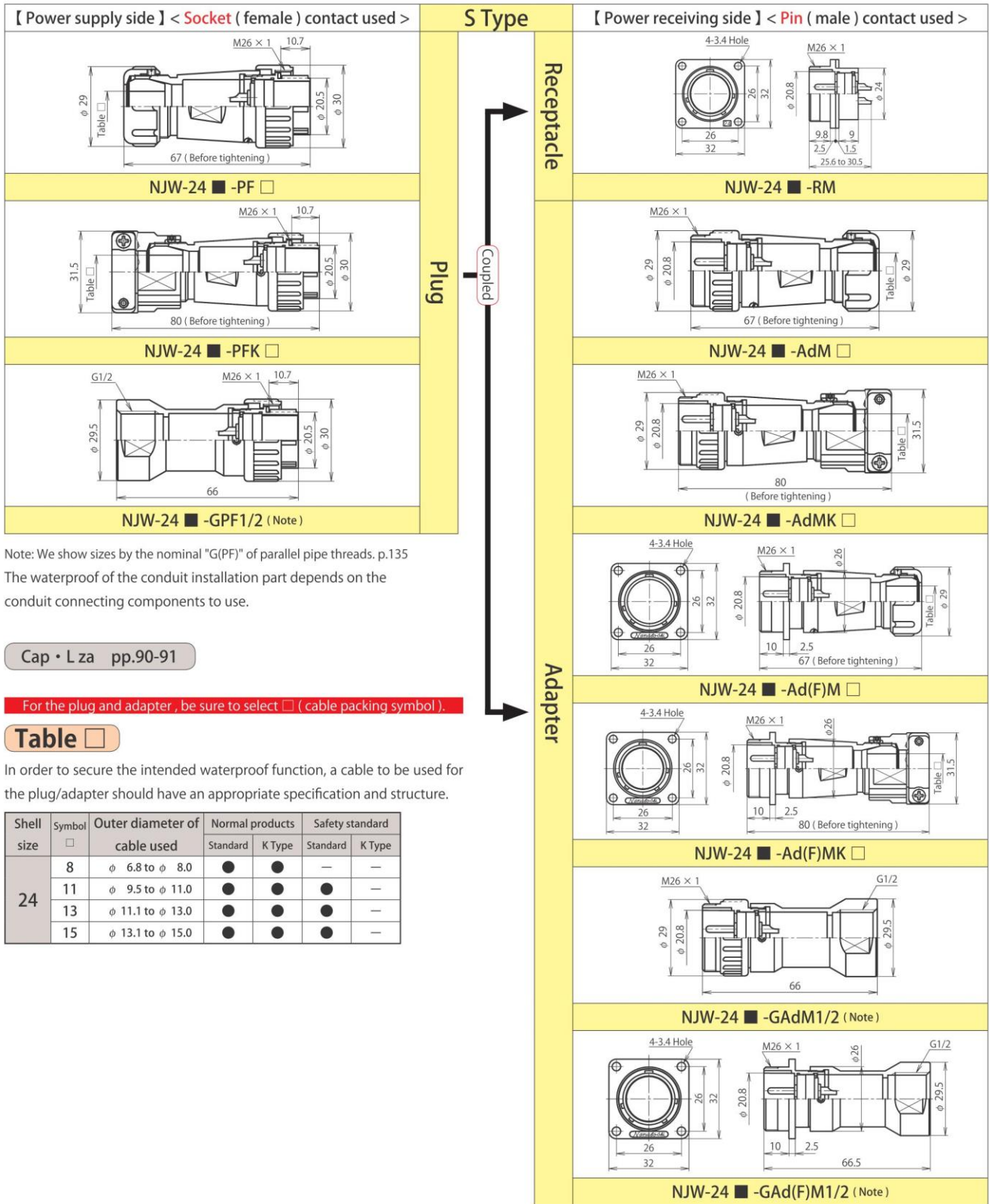

Note: We show sizes by the nominal "G(PF)" of parallel pipe threads. p.135
 The waterproof of the conduit installation part depends on the conduit connecting components to use.

Cap • Lza pp.90-91

For the plug and adapter, be sure to select (cable packing symbol).

Table

In order to secure the intended waterproof function, a cable to be used for the plug/adapter should have an appropriate specification and structure.

Shell size	Symbol <input type="checkbox"/>	Outer diameter of cable used	Normal products		Safety standard	
			Standard	K Type	Standard	K Type
24	8	φ 6.8 to φ 8.0	●	●	—	—
	11	φ 9.5 to φ 11.0	●	●	●	—
	13	φ 11.1 to φ 13.0	●	●	●	—
	15	φ 13.1 to φ 15.0	●	●	●	—

■ indicates the number of contacts. Contact arrangement p.78.
 The conductor cross sectional area is less than the following value. However, for safety standard certified products, use a cable having a value shown on p.128.

Shell size	Number of Contacts	2	3	4	5	10	14	16	21	24
24	Safety standard (Note-1)	UL-CSA								
	Rating (Allowable current for signals)	250V 20A	250V 15A		250V 10A	250V 5A		3pcs=6A [18pcs=3A]	[3A]	
	Withstand voltage (V r.m.s.)	1,500			1,000			500		
	Wire size (mm ²)	3.5	2		1.25	0.5		3pcs=0.75 18pcs=0.3	0.3	
	Remarks	—								

[] : Gold plating contact

Note-1 : Specified separately. *Specified as a set of UL and CSA". For safety standards, see p.128.

NJW Series Shell Size 28

【 Power receiving side 】 < Pin (male) contact used >

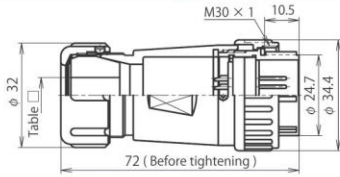

NJW-28 ■ -PM □

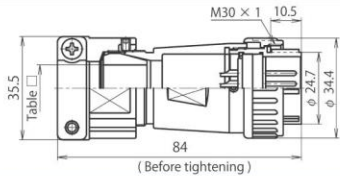

NJW-28 ■ -PMK □

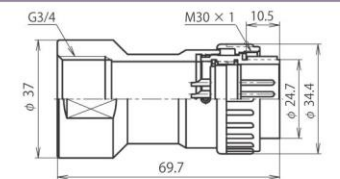

NJW-28 ■ -GPM3/4 (Note)

Note: We show sizes by the nominal "G(PF)" of parallel pipe threads. p.135
The waterproof of the conduit installation part depends on the conduit connecting components to use.

Cap · L za pp.90-91

For the plug and adapter, be sure to select □ (cable packing symbol).

Table □

In order to secure the intended waterproof function, a cable to be used for the plug/adapter should have an appropriate specification and structure.

Shell size	Symbol □	Outer diameter of cable used	Normal products		Safety standard	
			Standard	K Type	Standard	K Type
28	10	φ 9.0 to φ 10.9	●	●	—	—
	12	φ 11.0 to φ 12.4	●	●	—	—
	14	φ 12.5 to φ 14.0	●	●	●	—
	16	φ 14.1 to φ 16.0	●	●	●	—
	18	φ 16.1 to φ 18.0	●	●	●	—

G Type

【 Power supply side 】 < Socket (female) contact used >

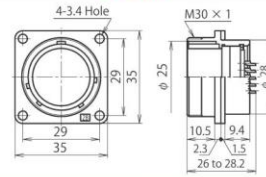

NJW-28 ■ -RF

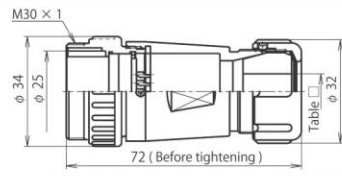

NJW-28 ■ -AdF □

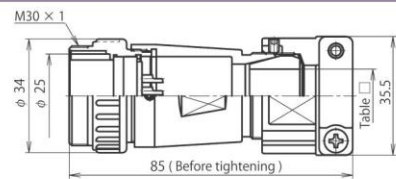

NJW-28 ■ -AdFK □

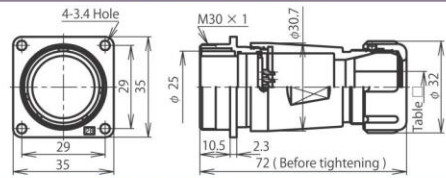

NJW-28 ■ -Ad(F)F □

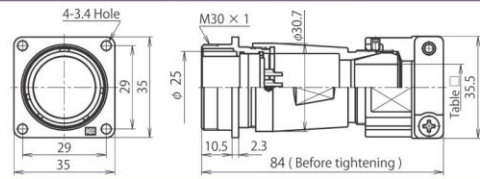

NJW-28 ■ -Ad(F)FK □

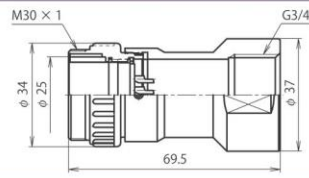

NJW-28 ■ -GAdF3/4 (Note)

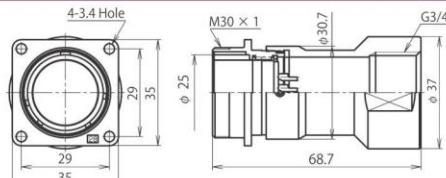

NJW-28 ■ -GAd(F)F3/4 (Note)

Plug

Coupled

Adapter

■ indicates the number of contacts. Contact arrangement p.79.
The conductor cross sectional area is less than the following value. However, for safety standard certified products, use a cable having a value shown on p.128.

Shell size	Number of Contacts	16	24	31	37
28	Safety standard (Note-1)	UL · CSA			—
	Rating (Allowable current for signals)	250V 10A	250V 5A	3pcs=6A [28pcs=3A]	[3A]
	Withstand voltage (V r.m.s.)	1,000		500	
	Wire size (mm ²)	1.25	0.5	3pcs=0.75 28pcs=0.3	0.3
	Remarks	—		For signals	

Note-1 : Specified separately. "Specified as a set of UL and CSA". For safety standards, see p.128.

[] : Gold plating contact

NJW Series Shell Size 28

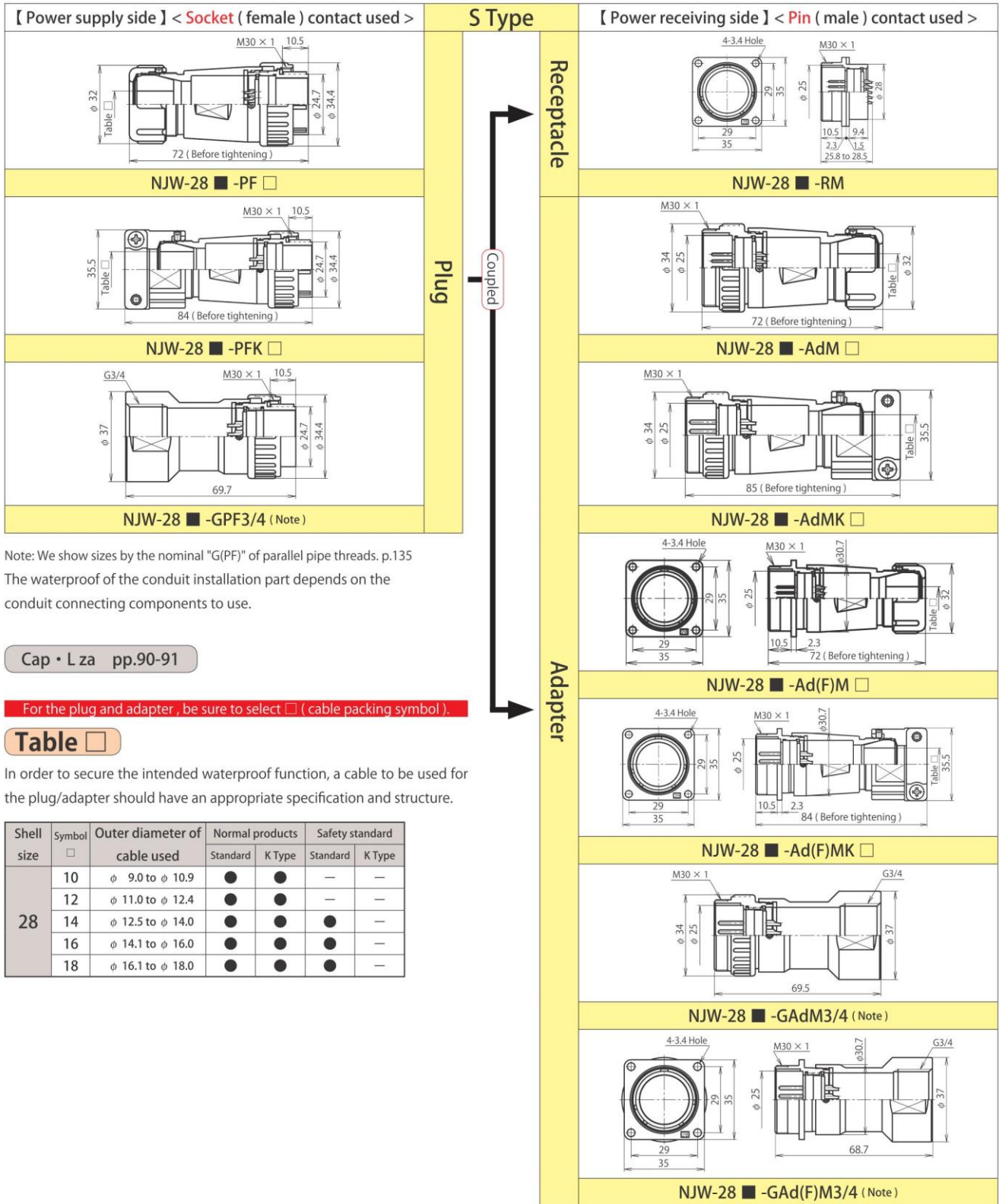

Note: We show sizes by the nominal "G(PF)" of parallel pipe threads. p.135
The waterproof of the conduit installation part depends on the conduit connecting components to use.

Cap · L za pp.90-91

For the plug and adapter, be sure to select □ (cable packing symbol).

Table □

In order to secure the intended waterproof function, a cable to be used for the plug/adapter should have an appropriate specification and structure.

Shell size	Symbol □	Outer diameter of cable used	Normal products		Safety standard	
			Standard	K Type	Standard	K Type
28	10	φ 9.0 to φ 10.9	●	●	—	—
	12	φ 11.0 to φ 12.4	●	●	—	—
	14	φ 12.5 to φ 14.0	●	●	●	—
	16	φ 14.1 to φ 16.0	●	●	●	—
	18	φ 16.1 to φ 18.0	●	●	●	—

■ indicates the number of contacts. Contact arrangement p.79.
The conductor cross sectional area is less than the following value. However, for safety standard certified products, use a cable having a value shown on p.128.

Shell size	Number of Contacts	16	24	31	37
28	Safety standard (Note-1)	UL·CSA			
	Rating (Allowable current for signals)	250V 10A	250V 5A	3pcs=6A [28pcs=3A]	[3A]
	Withstand voltage (V r.m.s.)	1,000		500	
	Wire size (mm ²)	1.25	0.5	3pcs=0.75 28pcs=0.3	0.3
	Remarks	—		For signals	

Note-1 : Specified separately. *Specified as a set of UL and CSA". For safety standards, see p.128.

[] : Gold plating contact

NJW Series Shell Size 32

N
J
W

32

【 Power supply side 】 < Socket (female) contact used >

NJW-32 ■ -PF □

NJW-32 ■ -GPF3/4 (Note)

Note: We show sizes by the nominal "G(PF)" of parallel pipe threads. p.135
The waterproof of the conduit installation part depends on the conduit connecting components to use.

Cap • L za pp.90-91

For the plug and adapter , be sure to select □ (cable packing symbol).

Table □

In order to secure the intended waterproof function, a cable to be used for the plug/adapter should have an appropriate specification and structure.

Shell size	Symbol □	Outer diameter of cable used	Normal products	Safety standard
32	16	φ 11.5 to φ 16.0	●	●
	20	φ 15.5 to φ 20.0	●	●

※ Size 32 is provided with cable clamp as a standard feature.

S Type

Coupled

【 Power receiving side 】 < Pin (male) contact used >

NJW-32 ■ -RM

NJW-32 ■ -AdM □

NJW-32 ■ -Ad(F)M □

NJW-32 ■ -GAdM3/4 (Note)

NJW-32 ■ -GAd(F)M3/4 (Note)

Plug

Receptacle

Adapter

■ indicates the number of contacts. Contact arrangement p.79.
The conductor cross sectional area is less than the following value. However, for safety standard certified products, use a cable having a value shown on p.128.

Shell size	Number of Contacts	3	4	8	10	12
32	Safety standard (Note-1)	UL • CSA				
	Rating (Allowable current for signals)	250V 30A		250V 10A		
	Withstand voltage (V r.m.s.)	2,000		1,500		
	Wire size (mm ²)	5.5 , 6		2		
	Remarks	—				

Note-1 : Specified separately. "Specified as a set of UL and CSA". For safety standards, see p.128.

NJW Series

◆ [AdCa] Adapter cap

Caps used for adapters. Used to protect the contact part when they are not coupled with a plug.
For adapters with flange, RCa may also be used.

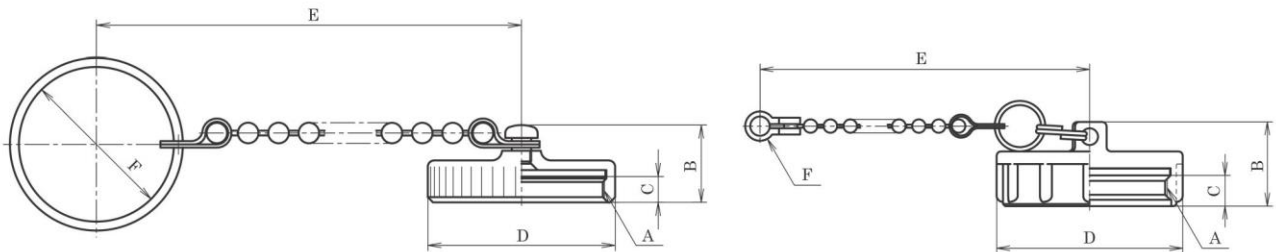

Photo shows Shell size 24

Shell size	Designation	Standard dimensions					
		A	B	C	D	E	F
16	NJW-16-AdCa	M18 × 1	11.5	3.5	φ 22	160	φ 21
20	NJW-20-AdCa	M22 × 1			φ 25		
24	NJW-24-AdCa	M26 × 1	12	4	φ 29	165	φ 24
28	NJW-28-AdCa	M30 × 1	12.5	4.5	φ 33		φ 28
32	NJW-32-AdCa	M37 × 1.5	20	7.3	φ 44	180	4.5 Hole

NJW-16 to 28

NJW-32



◆ [L za]

An angle part used in the receptacle mounting place to change the direction of a receptacle.
The plug and cable can be installed parallel with the panel.

Used commonly for NJW, NAW, NRW and NEW.

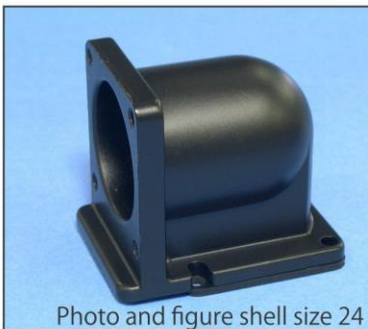
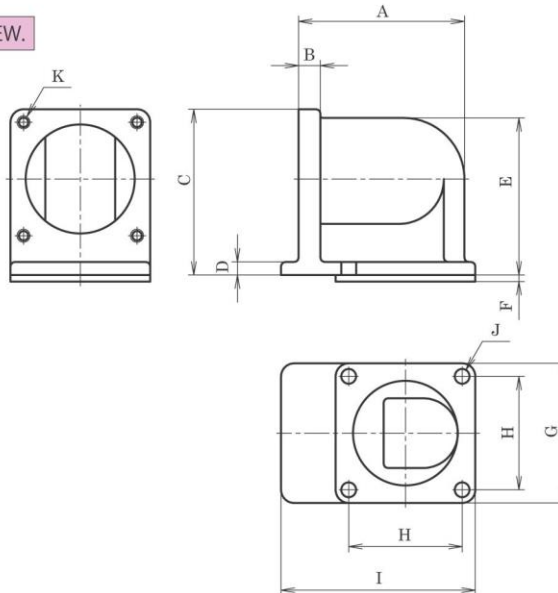
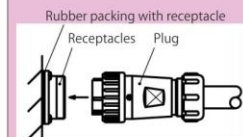

Photo and figure shell size 24



Example of use of L za



Shell size	Designation	Standard dimensions										
		A	B	C	D	E	F	G	H	I	J	K
16	NJW-16-L za	29.5	5	30.5	3	27.5	1.5	26	20	36.9	4-3.4 Hole	4-M3 tap
20	NJW-20-L za	32		35.3	5.3	32.8		29	23	38.4		
24	NJW-24-L za	38		38	3	36		32	26	44.5		
28	NJW-28-L za	41		41.5		40		35	29	46.8		

NJW Series Characteristics



Shell size	Contact	Insulation resistance (M Ω)		Contact resistance (m Ω)		Withstand voltage (V r.m.s.)	
		Normal products	Safety standard	Normal products	Safety standard	Normal products	Safety standard
			UL • CSA		UL • CSA		UL • CSA
16	3	DC 500V 2,000 min.		3 max.		1,500	
	5	DC 500V 1,000 min.		5 max.		1,000	
	8	DC 250V 1,000 min.	—	5 max.	—	500	—
20	2	DC 500V 2,000 min.		3 max.		1,500	
	3						
	4						
	5						
	7	DC 500V 1,000 min.		5 max.		1,000	
	10						
	12						
14	DC 250V 1,000 min.	—	5 max.	—	500	—	
24	2	DC 500V 5,000 min.		DC 500V 2,000 min.		3 max.	
	3						
	4						
	5						
	10	DC 500V 2,000 min.		5 max.		1,000	
	14	DC 500V 1,000 min.					
	16	DC 500V 1,000 min.					
	21	DC 250V 1,000 min.	—	5 max.	—	500	—
24	DC 250V 1,000 min.		—	5 max.	—	500	—
28	16	DC 500V 2,000 min.		3 max.		1,000	
	24	DC 500V 1,000 min.		5 max.			
	31	DC 250V 1,000 min.		5 max.		500	
	37						
32	3	DC 500V 2,000 min.		3 max.		2,000	
	4						
	8					1,500	
	10						
	12						

(Waterproof) No trace of water exposure after being kept at a water pressure of 40 kPa for 24 hours in the coupled state in its normal state of use.